

# Knauf MF Suspended Ceilings

## Installation Procedures

Knauf Ceiling systems are designed to be simple and fast to install. Knauf Technical Services are on hand should you have any questions or unusual situations to deal with.

### General

Knauf MF Ceiling Systems must be installed in accordance with Knauf's recommendations and the recommendations of BS 8212: 1995 and BS 8000: Part 8: 1994.

When creating an airtight space, methods for the reduction of potential 'ceiling lift' should be considered. For further advice contact Knauf Technical Services

### Perimeter Fixing 1

Knauf MF Perimeter Channels should be secured to the walls at the required heights, at maximum 600mm centres and 50mm from the ends of channels. The top of the Knauf MF Perimeter Channels should align with the underside of the Knauf MF Primary Support Channel.

The Knauf MF Perimeter Channels forming the perimeter and the Knauf Primary Support Channel do not need to be mechanically fixed together.

### Suspension 2

Select the fixing centres suited to the ceiling loading. See page 131.

Fix Knauf Soffit Cleats to the structural soffit with suitable fixings. Choose either Knauf Angle Section or the flexible Knauf Strap Hanger and fix to the Knauf Soffit Cleat, using Knauf MF Nut and Bolt. When creating a shallow ceiling void, Knauf Universal Brackets can be used.

### MF Primary Support Channels 3

The centres of the primary support channels depend on the loading requirement, determined in the MF loading information table on page 131.

Knauf Angle Section or Knauf Strap Hanger should be fixed to the Knauf Primary Support Channels with two Knauf Wafer Head Jackpoint Screws. The Primary Support Channels should lie on the upper flange of the Perimeter Channel.

### Joints in MF Ceilings

If straight lengths of Knauf MF Primary Support Channels need jointing, place the channels back to back, with a minimum 150mm overlap, and fix with two Knauf Wafer Head Jackpoint Screws.

### MF Ceiling Channels 4,5

The Knauf MF Ceiling Channels should be positioned at 450mm centres within the perimeter channels to coincide with the abutments of the boards, which will be fixed later.

Connect the Knauf MF Ceiling Channel to the Knauf MF Primary Support Channels by means of Knauf MF Connecting Clips. These clips fit over the Knauf MF Primary Support Channels and snap-fix over the MF Ceiling Channels.

### Insulation

Once the primary support and the ceiling channels have been connected and before the boarding has started, Knauf insulation as specified should be inserted above the primary support channels. Care should be taken to ensure that the insulation is fitted neatly without gaps at abutments or between different rolls.

### Movement Control Joints

Create movement control joints where ceiling runs exceed 10m, coinciding where possible with movement joints in the surrounding structure.

### Boarding 6,7,8

All boards should be offered up to the ceiling grid with the decorative face of the boards outwards and secured with Knauf Screws at maximum 230mm centres. Fixing centres should be reduced to 150mm at ends and perimeter.

Boards should be mounted at 90° to the direction of the ceiling channels.

Once Knauf Plasterboards have been installed, spray apply Knauf Readymix plasters to finish ceiling ready for decoration.

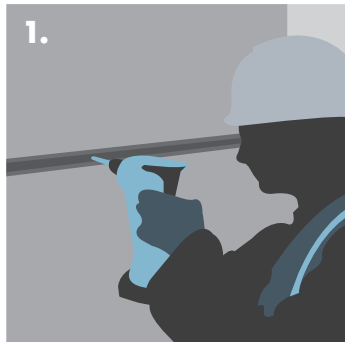

1. Fixing Knauf MF Perimeter Channel.

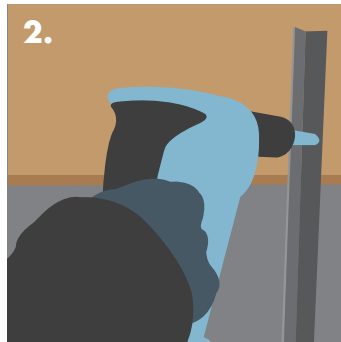

2. Fixing the Knauf Angle Section to the joist to form hanger.

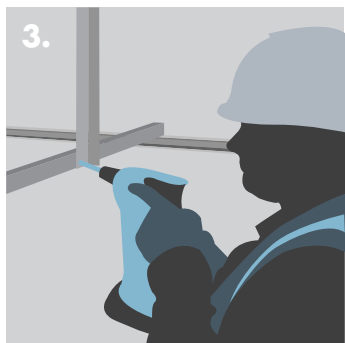

3. Fixing the Knauf Angle Section to Knauf MF Primary Support Channel.

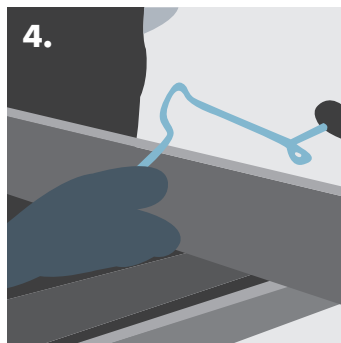

4. Connect the Knauf Primary Support Channel to Knauf MF Ceiling Channel with Knauf MF Connecting Clips.

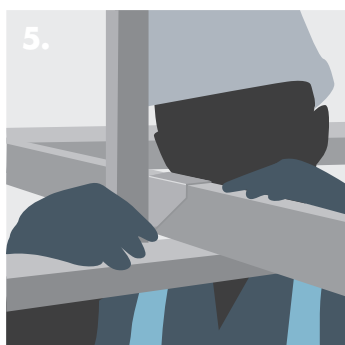

5. Adjusting the Knauf MF Ceiling Channel.

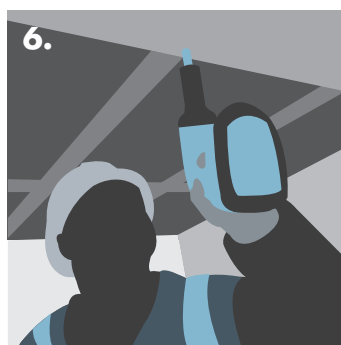

6. Fixing Knauf Plasterboard to Knauf MF Ceiling Channels.



7. Knauf Universal Brackets can be used as an alternative to Knauf Angle Section for shallow voids.

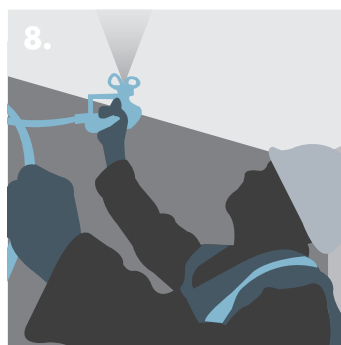

8. Spray-applied Knauf Readymix Plasters make finishing ceilings safe, easy and fast.

