

Knauf Direct Bonding and Metal Furring

Installation Procedures

Knauf linings are designed to be simple and fast to install. Knauf Technical Services are on hand should you have any questions or unusual situations to deal with.

General

Knauf Direct Bonding and Metal Furring lining systems must be installed in accordance with Knauf's recommendations and the recommendations of BS 8212: 1995 and BS 8000: Part 8: 1994.

Preparation

Pre-treat backgrounds if necessary and remove all release agents.

If Direct Bonding a masonry separating wall, it may be necessary to apply a coat of Knauf Gypsum Parge Coat at a minimum thickness of 6mm to the entire wall surface. Ensure all gaps are sealed, especially at junctions and corners. Knauf Gypsum Parge Coat should have a key applied, and then be allowed to set fully prior to Direct Bonding with Knauf Plasterboards.

In all instances, the background should be plumbed for alignment, making allowances for over-sailing high spots on the masonry. Mark guidelines on the floor and soffit to establish the new wall plane. Mark vertical guidelines on the background to establish the bonding positions as determined by lining system type and the board size and thickness as shown in the table below.

Perimeter 1

A continuous band of Knauf Plasterboard Adhesive should be applied around the wall perimeter, service penetrations and openings to improve the airtightness and reduce the effects of cold convection currents impairing the thermal performance of the wall construction.

Application of Knauf Plasterboard Adhesive and Boarding 2

Apply Knauf Plasterboard Adhesive dabs, spaced intermittently up the wall along the vertical guidelines. The size and position of the dabs will vary depending on the dry lining system being used.

Direct Bonding 3,4

If Direct Bonding, dabs should be applied at 300mm vertical centres and each dab should be 250mm long and 50mm to 75mm wide. The dabs should be applied between 10mm and 25mm thick and sufficient for the fixing of one board at a time.

After dabbing out and before the dabs have set, offer up the plasterboard and press firmly into place, aligning the board so that it is plumb. Ensure the plasterboard is clear of the ground by at least 10mm; this can be accommodated by an off-cut of board. Modest pressure on the plasterboard will ensure a positive bond.

Knauf Insulating Laminates require secondary fixing with two mid-placed Knauf Nailable Plugs, penetrating the backgrounds through the dab by at least 40mm.

Metal Furring 5,6,7, 8

When using the Knauf Metal Furring system, dabs should be applied at 450mm centres and each dab should be 200mm long and 50mm wide.

Knauf Metal Furring Channels should be bedded into the dabs and continuous bands of Knauf Plasterboard Adhesive. These can be manipulated with a straight edge to ensure that they align with the guidelines marked on the floor.

Additional lengths of Knauf Metal Furring Channel are positioned around service penetrations and door and window openings.

Once the Knauf Plasterboard Adhesive has fully set (approximately 3–4 hours), Knauf Plasterboards can be screw-fixed into the Metal Furring Channels using Knauf Screws at nominal 300mm centres. Fixings should be to all vertical and horizontal sections of Knauf Metal Furring Channel.

Dab centres when direct bonding using Knauf Plasterboard Adhesive

Thickness of Wallboard	Width	Adhesive Centres	Row of Dabs per Board
9.5mm	900mm	450mm	3
9.5mm	1200mm	400mm	4
12.5mm	1200mm	600mm	3

Generate specifications at www.knauf.co.uk

Direct Bonding



1. Applying a continuous band of Knauf Plasterboard Adhesive around the perimeter.



2. Applying Knauf Plasterboard Adhesive dabs at the required centres.



3. Offering up Knauf Plasterboard and pressing into place.



4. Offering up Knauf Insulating Laminate for a better thermal performance.

Metal Furring



5. Applying Knauf Plasterboard Adhesive around the perimeter and at the required centres.



6. Ensuring Knauf Metal Furring Channels are fixed plumb.

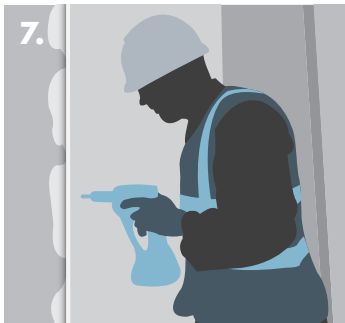

7. Fixing Knauf Plasterboard onto the Knauf Metal Furring Channel.



8. Finishing using Knauf Plaster.

Knauf Training Courses

We offer a range of comprehensive training courses at our purpose-built training schools to ensure the installer is fully up to speed with the latest techniques and regulations. See page 276 for more information.

